

FERRULE FOR HOSE 1SN-R1AT - 2SC no skive

Code: **8003..**
Type: **BPT1**

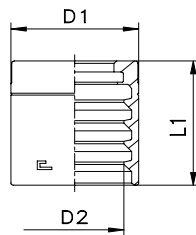

CODE	I.D. hose		Dimensions [mm]			Skiving lenght
	INCH	DN	D1	D2	L1	
800301	3/16	5	18	12,2	23,5	-
800302	1/4	6	19	13,9	25,5	-
800303	5/16	8	21	15,5	26,5	-
800304	3/8	10	23	17,7	27	-
800305	1/2	12	27,5	21,2	29	-
800306	5/8	16	31	24,4	32	-
800307	3/4	19	35	28,3	36	-
800308	1	25	43	36,5	44,5	-
800309	1 1/4	31	51	44,5	48	-
800310	1 1/2	38	58	51,2	55	-

Notes: If you wish to order a fitting in stainless steel, please change the first two digit from **80....** to **81....** .

FERRULE FOR HOSE 2SN-R2AT no skive

Code: **8004..**
Type: **BPT2**

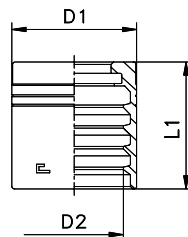

CODE	I.D. hose		Dimensions [mm]			Skiving lenght
	INCH	DN	D1	D2	L1	
800401	3/16	5	20	13,8	23,5	-
800402	1/4	6	21	15,5	25,5	-
800403	5/16	8	23	17	26,5	-
800404	3/8	10	24,5	19,4	27	-
800405	1/2	12	28	22,6	29	-
800406	5/8	16	32	25,9	32	-
800407	3/4	19	36	29,7	36	-
800408	1	25	45	38,3	44,5	-
800409	1 1/4	31	56	48,4	48	-
800410	1 1/2	38	64	55,3	55	-

Notes: If you wish to order a fitting in stainless steel, please change the first two digit from **80....** to **81....** .